

REV.	DESCRIPTION	BY	DATE
A	ADD RAD'S DIM. AND REVISED HORZ. DIM.	MS	06-JUN-17

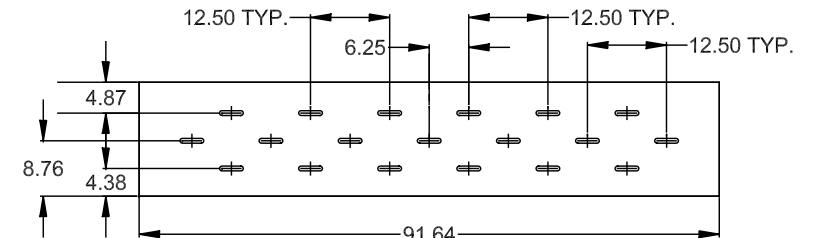

BLIND NO: 1,2,3,& 4.  
#4 - PCS. REQ'D

CHROMIUM CARBIDE ON THE O.D. OF THE PLATE

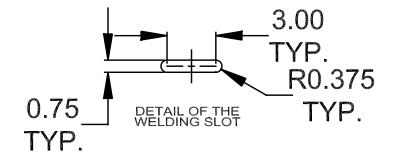
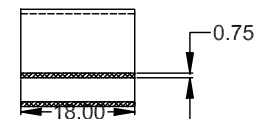
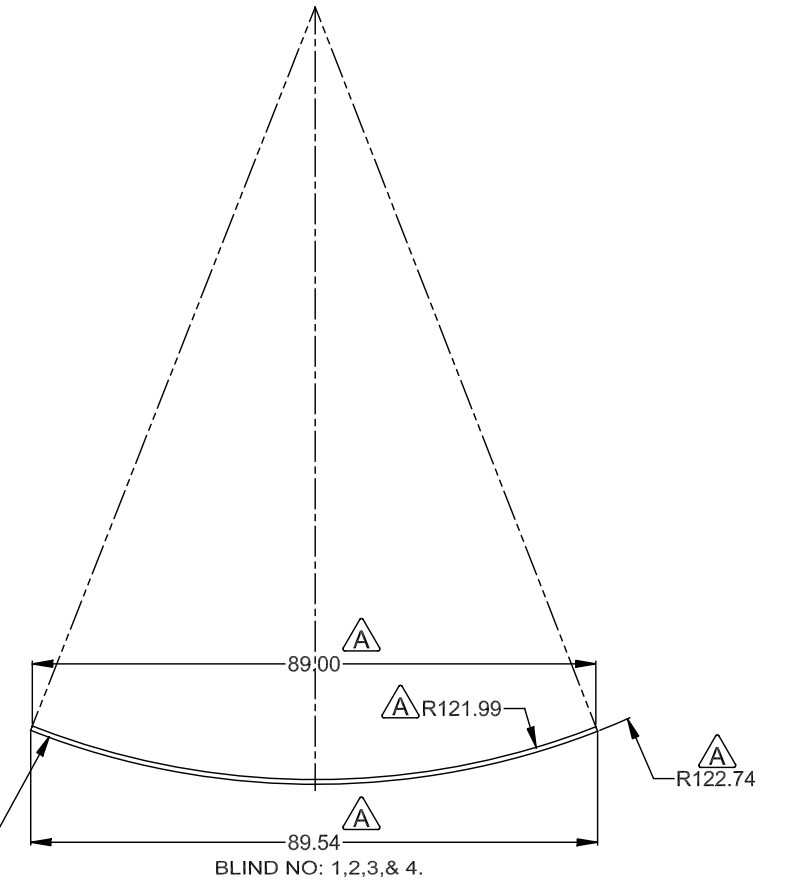

Confidential  
 MANUFACTURING NOTES:  
 TOLERANCES:  
 2 DECIMAL ± 0.030  
 3 DECIMAL ± 0.010  
 ANGULAR ± 1°  
 MACHINED SURFACES TO BE 125√ UNLESS OTHERWISE SPECIFIED.

ITEM	QTY	UOM	DESCRIPTION	PART No.
UNLESS SPECIFIED, ALL UNITS ARE: IMPERIAL: <input checked="" type="checkbox"/> (Inches) METRIC: <input type="checkbox"/> (MM)				
DESIGNED:		06-JAN-16	MVS	<b>Lovsuns Tunneling Canada Ltd</b> TITLE: CUTTINGHEAD STRUCTURAL CHROMIUM CARBIDE PLATE BLIND SECTOR ASSEMBLY SCALE: NTS DRAWING NO.: 475119 SHEET: S01 REV: A
DRAWN:		06-JAN-16	MVS	
REVIEWED:		06 Jun 17	MVS	
APPROVED:		06 Jun 17	JZ	
		DD-MMM-YY	BY	

ITEM NO.	QTY. (EA)	UOM	LENGTH/UNIT	AREA/UNIT	DESCRIPTION	PARTNUMBER	MATL DESCRIPTION	MATL NUMBER
1	4	SQ IN		1649		475119-T001	PLATE, 19.00MM, CHROMIUM CARBIDE, 10MM BASE	